

# Agilent InfinityLab Quick Connect Fittings

Less stress, more reliable connections



Save time and trouble with these key features



Truly finger-tight connection



Spring-loaded design



Reliable and reusable



Fast, easy connections

## Three simple steps, one perfect connection

Badly connected fittings are one of the top reasons for broad or tailing peaks, loss of resolution, and overall poor chromatography. With Agilent InfinityLab Quick Connect fittings, you can be sure you're getting a perfect column connection, every time.

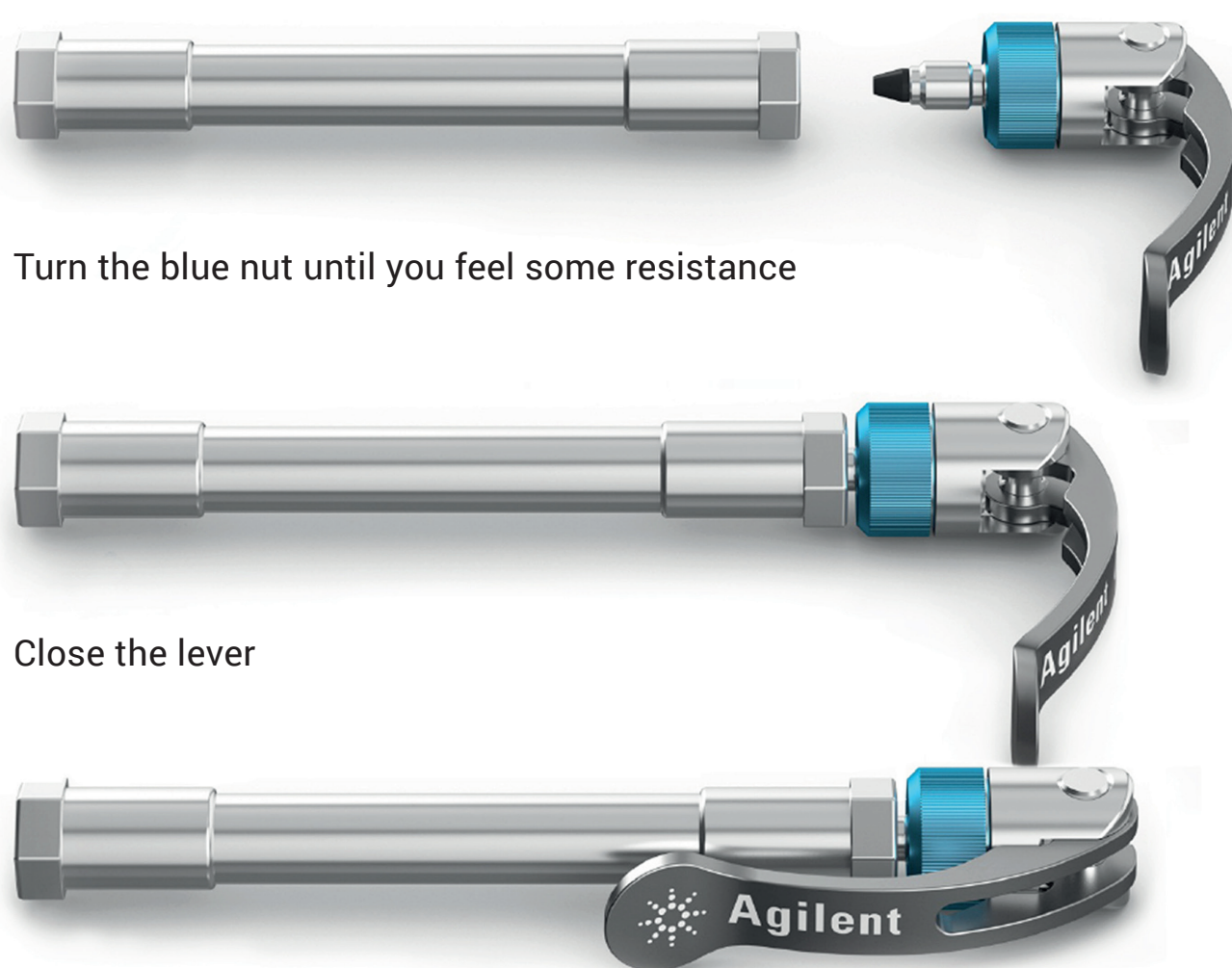

Turn the blue nut until you feel some resistance

Close the lever

The proprietary Agilent design features a spring-loaded mechanism for zero dead volume and a sure, tight connection to 1300 bar.

## Significantly reduce your costs and increase economic value



Up to 200 uses against only a few for traditional fittings



No training needed

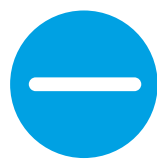

Less time connecting fittings

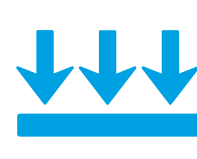

Fewer damaged columns



Reliable chromatographic performance

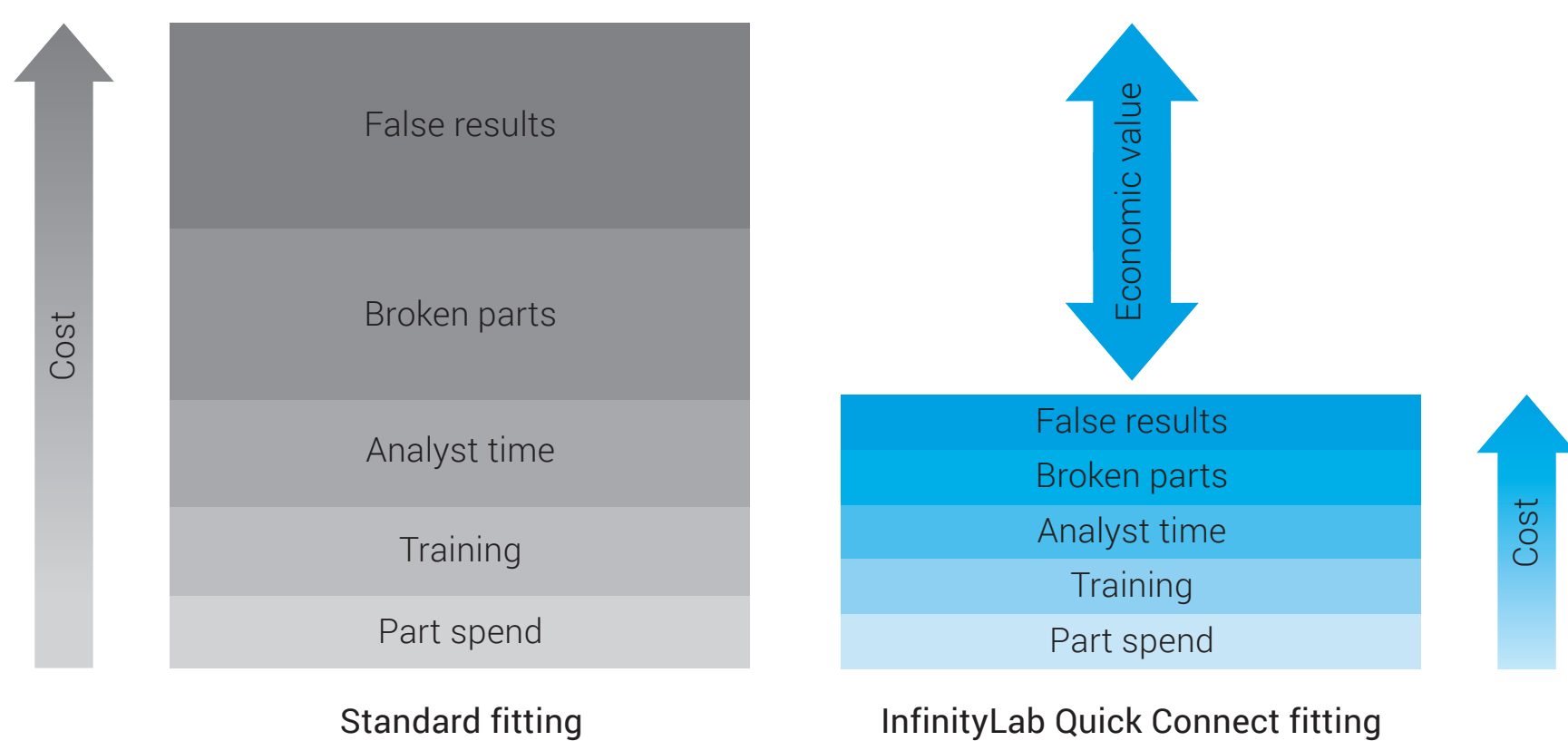

Agilent InfinityLab Quick Connect fittings can deliver superior chromatographic performance and save you money:

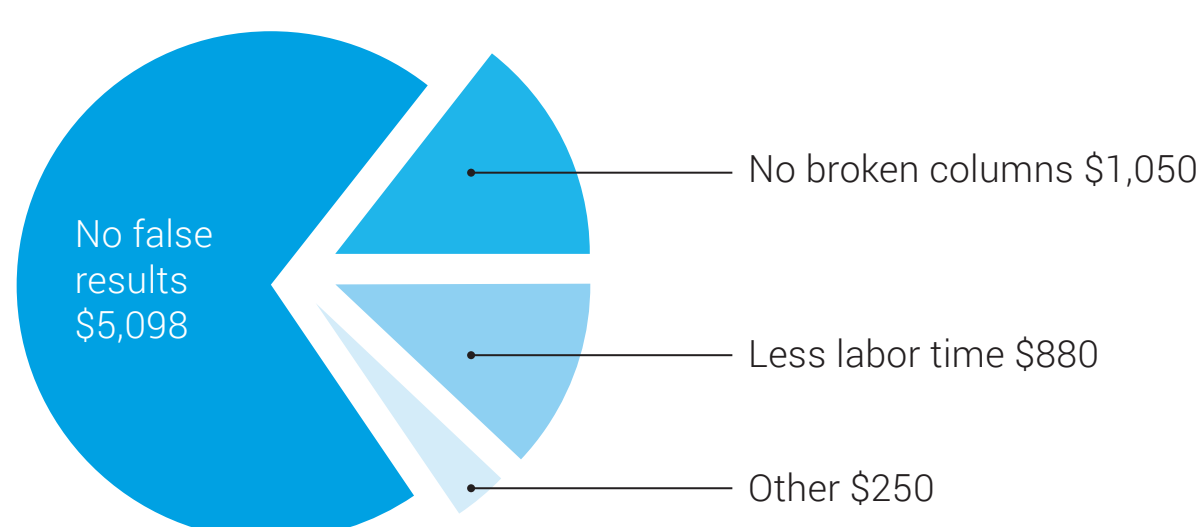

Learn more about how Agilent InfinityLab Quick Connect fittings can significantly reduce your costs and improve performance:

[www.agilent.com/chem/infinitylab](http://www.agilent.com/chem/infinitylab)



This information is subject to change without notice.

© Agilent Technologies, Inc. 2019  
Published in the USA, February 28, 2019  
5994-0749EN